

# PROKIT EP 200

## The side protection for increased requirements

Product Brochure – Issue 12/2017

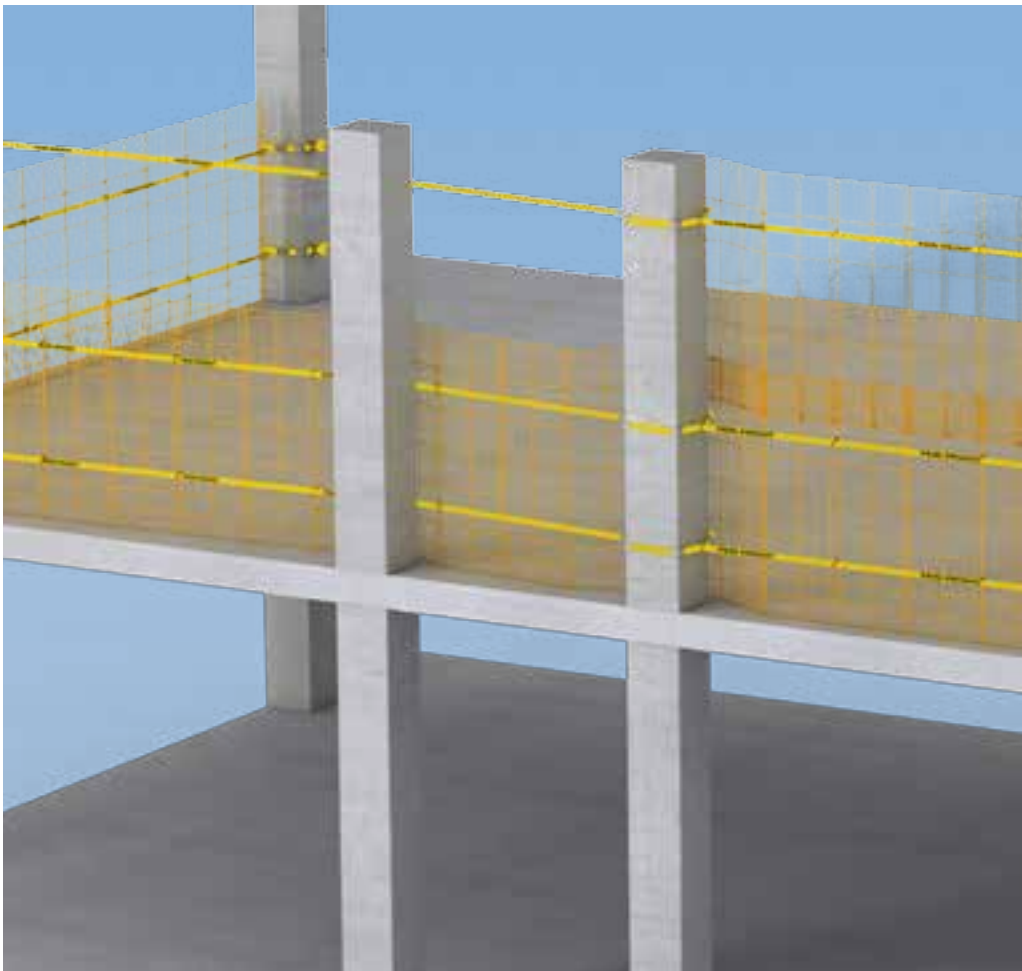

# Content

- System advantages**
- 4 The side protection for increased requirements
  - 6 Fast assembly

- System supplements**
- 7 Practical system supplements

**Issue 12/2017**

**Publisher**

**PERI GmbH**  
**Formwork Scaffolding Engineering**  
Rudolf-Diesel-Strasse 19  
89264 Weissenhorn  
Germany  
Tel. +49 (0)7309.950-0  
Fax +49 (0)7309.951-0  
info@peri.com  
www.peri.com

## Components

### 8 Components

#### Important information

All current safety regulations and guidelines applicable in those countries where our products are used must be observed.

The photos shown in this brochure feature construction sites in progress. For this reason, safety and anchor details in particular cannot always be considered as conclusive or final. These are subject to the risk assessment carried out by the contractor.

In addition, computer graphics are used which are to be understood as system representations. For ensuring a better understanding, these and the detailed illustrations shown have been partially

reduced to show certain aspects. The safety installations which have possibly not been shown in these detailed descriptions must nevertheless still be available. The systems or items shown might not be available in every country.

Safety instructions and load specifications are to be strictly observed at all times. Separate structural calculations are required for any deviations from the standard design data.

The information contained herein is subject to technical changes in the interests of progress. Errors and typographical mistakes reserved.

## The side protection for increased requirements



**PROKIT EP 200 protects site personnel during construction of building shells against falling. The system ensures safe working areas and access ways thus increasing safety levels of jobsite personnel as well as improving work efficiency. In addition, the 2.00 m high mesh barriers prevent material from falling off the edge of the building. With just a few individual components, PROKIT EP 200 can be assembled very quickly without any tools.**

Assembly of the PROKIT EP 200 anti-fall protection is extremely simple: high-quality tension belts – securely connected between two supports – serve as a mounting support for the PROKIT Fold Mesh. The 2.00 m high,

close-meshed barriers are easily attached to the tension belts with cable ties. Mounting this anti-fall protection is thus carried out completely independent of the slab itself, and the concrete components remain undamaged.

The mesh barrier only weighs 7.5 kg and provides enhanced work ergonomics. The yellow powder coating increases the signal effect at the hazardous area; it is very durable and ensures a long life of the mesh screen.

If necessary, e.g. for inner-city construction sites, 2 screens can be arranged one on top of each other as a floor-to-slab enclosure. With additional netting, the PROKIT EP 200 can also be used as dust protection.

- **Reliable and safer protection** against falling from open edges on building shells (in accordance with DIN EN 13374, Class A).
- **Fast assembly** with only a minimum of lightweight individual components as well as easy to handle connecting means such as tension belts and cable ties.
- **Floor-to-ceiling enclosure** up to 3.90 m for optimal protection with increased requirements.
- **Slab-independent fixing** without any damage to the existing building structure

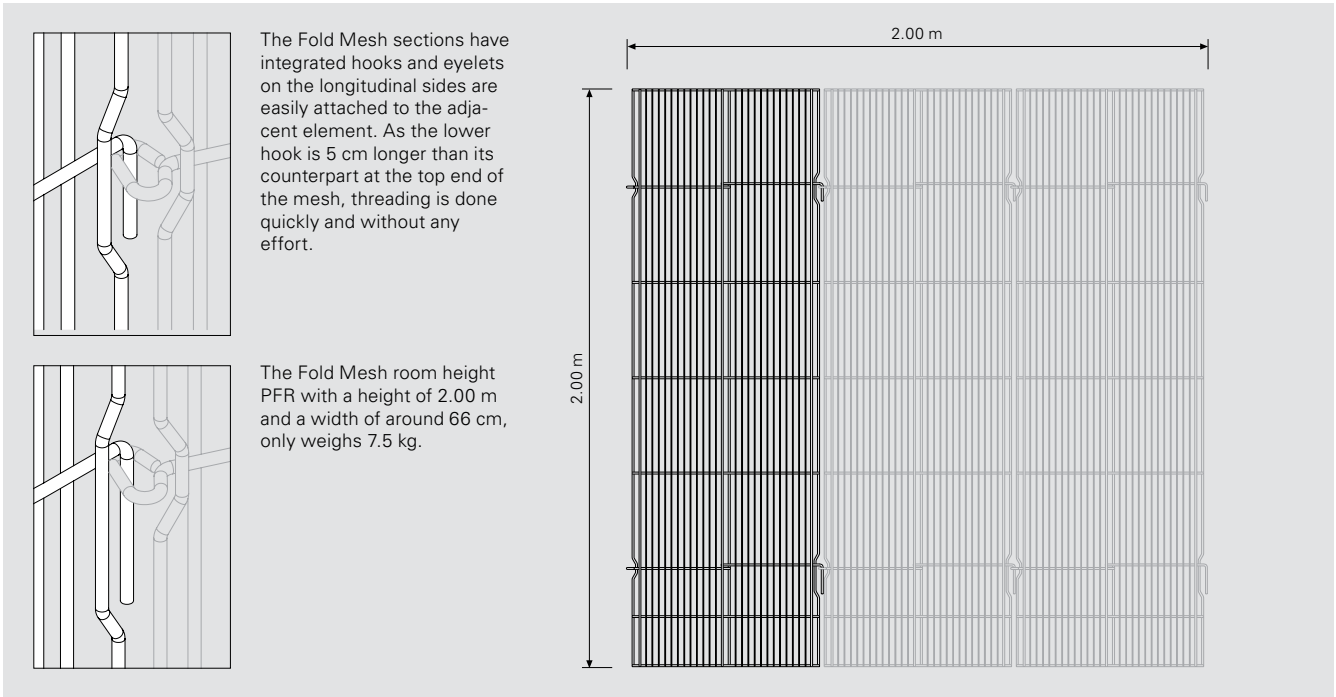

The Tension Belt PTB 12 is tensioned between two supports and forms the sub-construction for the Fold Mesh PFR. The two-piece belt with a length of 12.00 m is equipped with hooks and securing straps.



The tension belts are pulled through the eyelets, the hooks are attached which closes the strap around the support.



Cable Ties PCT serve to attach the Fold Mesh to the Tension Belts. They are matched to the system and UV-resistant.



For preventing any damage to the support edges, a plastic hose is used which is pulled over the tension belt.

## Fast assembly

### Belt assembly in detail

The extremely tear-resistant belt is placed around the first support, then looped around the second column. The ratchet is used to tighten with around 5 kN to 6 kN preload force.

PROKIT Tension Belts are approved and tested according to EN 12195-2 and the corresponding label is sewn on the lashing strap.

If required, two meshes can also be mounted one on top of the other with the overall height then reaching up to 3.90 m. However, three tension belts are normally sufficient. If securing working operations means that the mesh is installed directly up to under the slab, four tension belts are to be used.



The fold mesh construction can easily be adjusted to suit wall offsets.



The mesh simply bypasses any columns positioned along the installation path.



The powder-coated mesh barrier can also be used as rear safety protection for climbing formwork.





# Practical system supplements

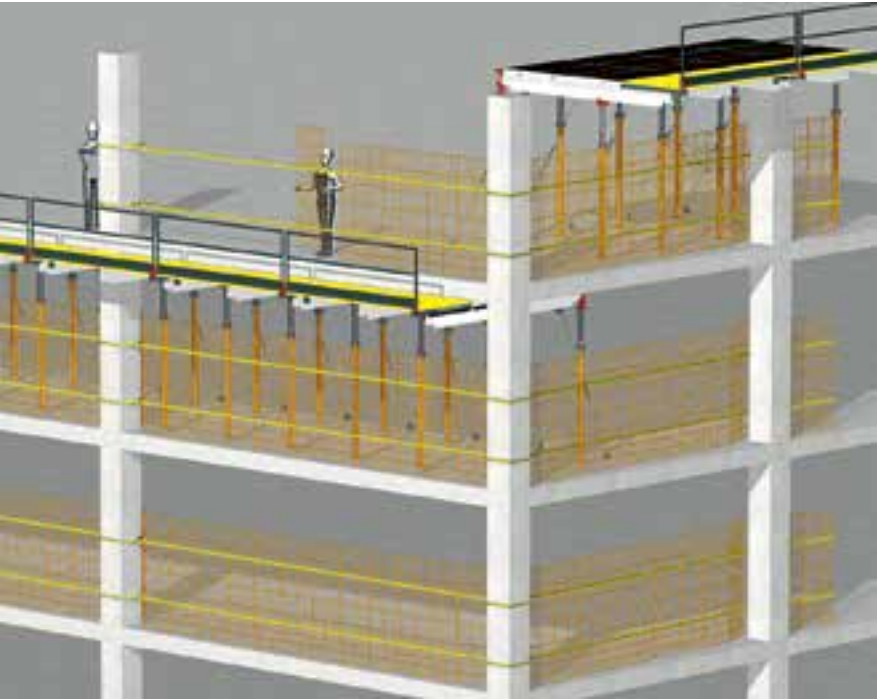

PERI PROKIT EP 200 is suitable in particular for use in high skeleton structures. The design of the 2.00 m high side protection gives site personnel a greater sense of security so that working efficiency at large heights is increased.

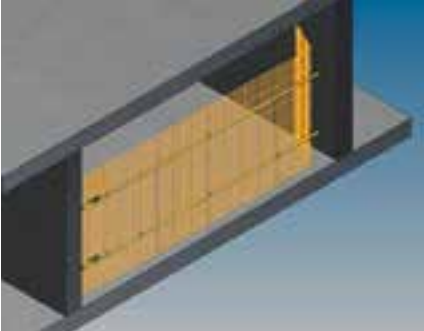
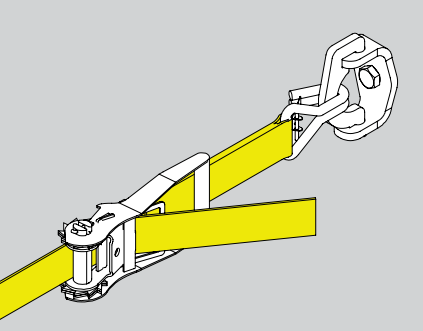

With the galvanized Wall Fixing PWF, the tension belts can be fixed to the rising walls.

Also on working platforms, the PROKIT Fold Mesh serves as 2.00 m high protection.

For easy handling and safe logistics. 45 meshes can be stacked and transported on one pallet.



Item no.	Weight kg
118350	7.690

**Fold Mesh Room Height PFR**  
Need horizontal support.

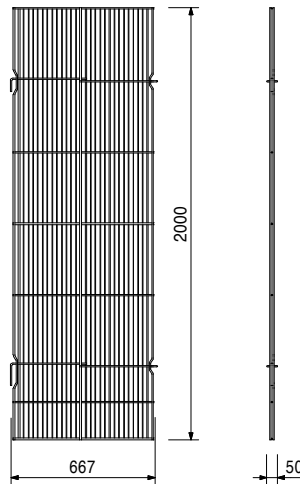
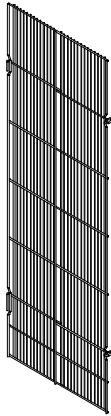

118349	3.530
--------	-------

**Tension Belt PTB 12**  
Two parts.

**Note**  
Consider information on the belt Label!  
**Technical Data**  
Total length 12 m, max. span 8 m.  
Permissible tension force 2.5 t.

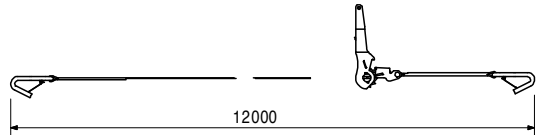
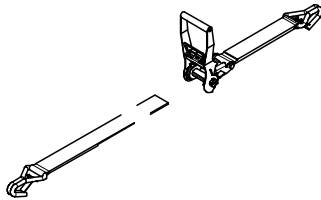

118408	0.006
--------	-------

**Cable Tie PCT**  
For fixation of the barriers to the tension belts.

**Technical Data**  
Black, uv-resistant.  
Permissible load: 0.8 kN.

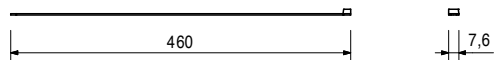
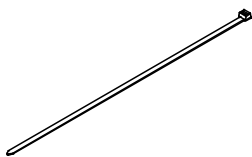

117200	0.244
--------	-------

**Eyelet-2 PE**  
For easy interconnection of tension belts.

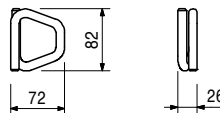



Item no.	Weight kg
118494	0.224

**Edge Protector Hose PEH 1 m**  
To protect the edges and the tension belt.

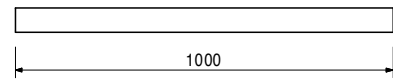
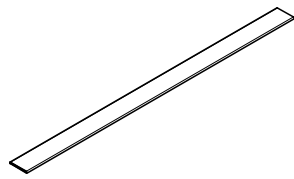

118493	0.137
--------	-------

**Edge Protection Plate PEP**  
To protect the edges.

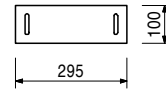
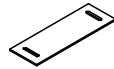

118405	0.918
--------	-------

**Wall Fixing PWF**  
For attaching the tension belts to concrete walls.

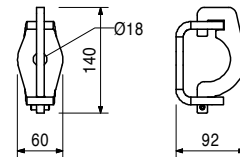

Accessories

117020	0.213
--------	-------

**Anchor Bolt PERI 14 x 150**

118406	1.920
--------	-------

**MP Mounting PMF**

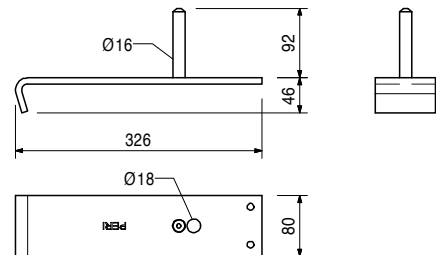
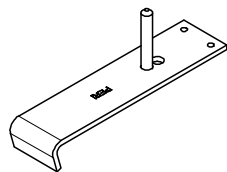

117020	0.213
--------	-------

**Anchor Bolt PERI 14 x 150**  
Re-usable.  
Approval available.

**Note**  
Separate Design Information on request.

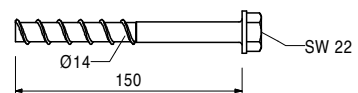
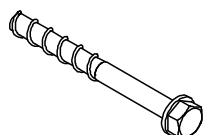

Item no.	Weight kg
035500	72.800

**Stripping Cart, Alu**

Mobile working scaffold. Height-adjustable in 25-cm-increments. Platform height max. 2.00 m.

**Note**

Follow Instructions for Use!

**Technical Data**

Permissible load 100 kg/m<sup>2</sup>.

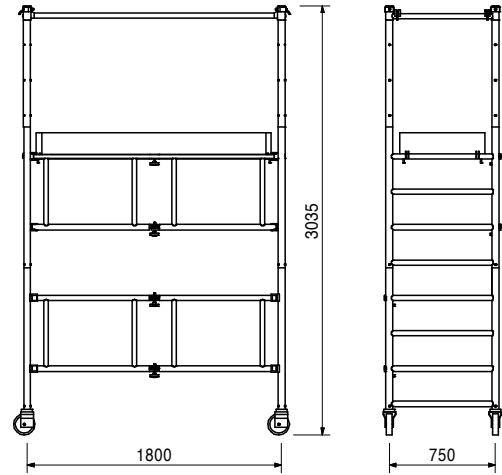
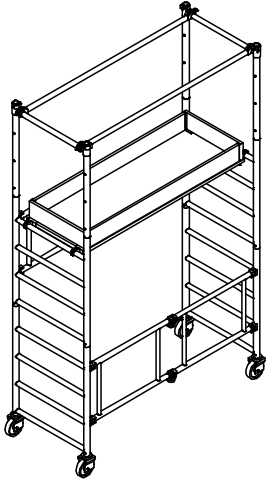

103434	38.500
--------	--------

**Pallet RP-2 80 x 120, galv.**

For stacking and transportation of formwork and scaffolding components.

**Note**

Follow Instructions for Use!

**Technical Data**

Permissible load-bearing capacity 1.5 t.

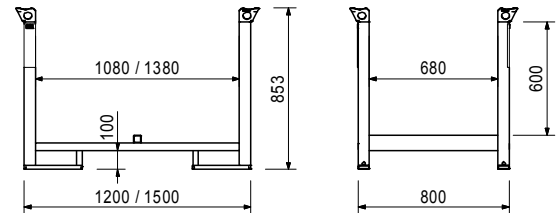
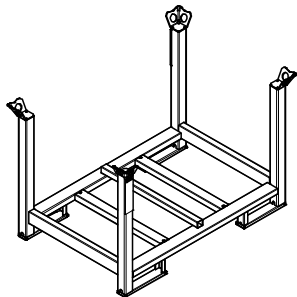

# PERI International

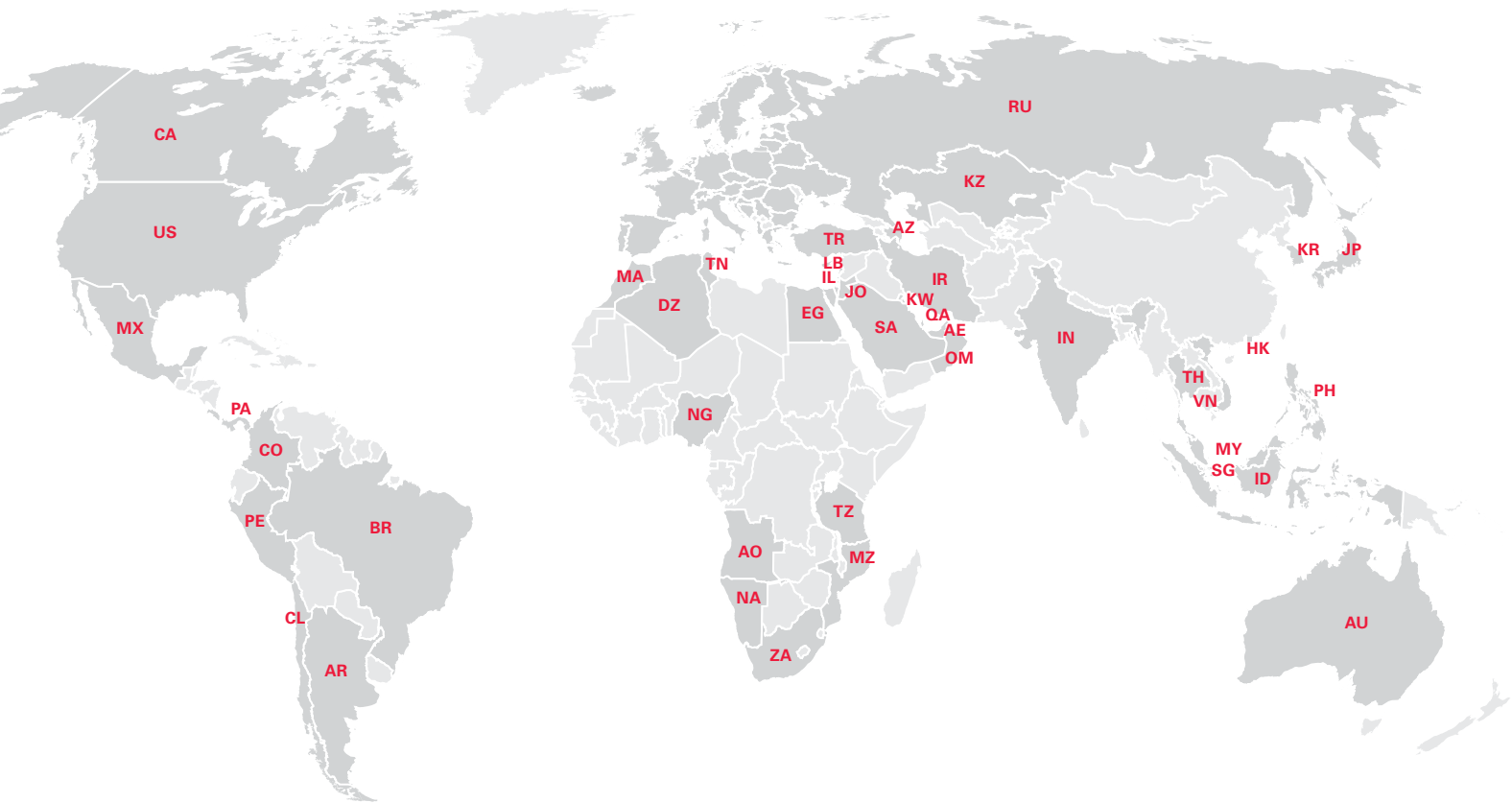

## North America

- CA** Canada  
PERI Formwork Systems, Inc.  
[www.peri.ca](http://www.peri.ca)
- MX** Mexico  
PERI Cimbras y Andamios, S.A. de C.V.  
[www.peri.com.mx](http://www.peri.com.mx)
- PA** Panama  
PERI Panama Inc.  
[www.peri.com.pa](http://www.peri.com.pa)
- US** USA  
PERI Formwork Systems, Inc.  
[www.peri-usa.com](http://www.peri-usa.com)

## South America

- AR** Argentina  
PERI S.A.  
[www.peri.com.ar](http://www.peri.com.ar)
- BR** Brazil  
PERI Formas e Escoramentos Ltda.  
[www.peribrasil.com.br](http://www.peribrasil.com.br)
- CL** Chile  
PERI Chile Ltda.  
[www.peri.cl](http://www.peri.cl)
- CO** Colombia  
PERI S.A.S.  
[www.peri.com.co](http://www.peri.com.co)
- PE** Peru  
PERI Peruana S.A.C.  
[www.peri.com.pe](http://www.peri.com.pe)

## Africa

- AO** Angola  
Pericofragens, Lda.  
[www.peri.pt](http://www.peri.pt)
- DZ** Algeria  
S.A.R.L. PERI  
[www.peri.dz](http://www.peri.dz)
- EG** Egypt  
Egypt Branch Office  
[www.peri.com.eg](http://www.peri.com.eg)
- MA** Morocco  
PERI S.A.  
[www.peri.ma](http://www.peri.ma)
- MZ** Mozambique  
PERI (Pty.) Ltd.  
[www.peri.co.mz](http://www.peri.co.mz)
- NA** Namibia  
PERI (Pty.) Ltd.  
[www.peri.na](http://www.peri.na)
- NG** Nigeria  
PERI Nigeria Ltd.  
[www.peri.ng](http://www.peri.ng)
- TN** Tunisia  
PERI S.A.U.  
[www.peri.es](http://www.peri.es)
- TZ** Tanzania  
PERI Formwork and Scaffolding Ltd  
[www.peri.co.tz](http://www.peri.co.tz)
- ZA** South Africa  
PERI Formwork Scaffolding (Pty) Ltd  
[www.peri.co.za](http://www.peri.co.za)

## Asia

- AE** United Arab Emirates  
PERI (L.L.C.)  
[www.peri.ae](http://www.peri.ae)
- AZ** Azerbaijan  
PERI Representative Office  
[www.peri.com.tr](http://www.peri.com.tr)
- HK** Hong Kong  
PERI (Hong Kong) Limited  
[www.perihk.com](http://www.perihk.com)
- ID** Indonesia  
PT Beton Perkasa Wijaksana  
[www.betonperkasa.com](http://www.betonperkasa.com)
- IL** Israel  
PERI F.E. Ltd.  
[www.peri.co.il](http://www.peri.co.il)
- IN** India  
PERI (India) Pvt Ltd  
[www.peri.in](http://www.peri.in)
- IR** Iran  
PERI Pars. Ltd.  
[www.peri.ir](http://www.peri.ir)
- JO** Jordan  
PERI GmbH – Jordan  
[www.peri.com](http://www.peri.com)
- JP** Japan  
PERI Japan K.K.  
[www.peri.co.jp](http://www.peri.co.jp)
- KR** Korea  
PERI (Korea) Ltd.  
[www.perikorea.com](http://www.perikorea.com)
- KW** Kuwait  
PERI Kuwait W.L.L.  
[www.peri.com.kw](http://www.peri.com.kw)
- KZ** Kazakhstan  
TOO PERI Kazakhstan  
[www.peri.kz](http://www.peri.kz)
- LB** Lebanon  
PERI Lebanon Sarl  
[lebanon@peri.de](mailto:lebanon@peri.de)
- MY** Malaysia  
PERI Formwork Malaysia Sdn. Bhd.  
[www.perimalaysia.com](http://www.perimalaysia.com)
- OM** Oman  
PERI (L.L.C.)  
[www.peri.ae](http://www.peri.ae)
- PH** Philippines  
PERI-Asia Philippines, INC.  
[www.peri.com.ph](http://www.peri.com.ph)
- QA** Qatar  
PERI Qatar LLC  
[www.peri.qa](http://www.peri.qa)
- SA** Saudi Arabia  
PERI Saudi Arabia Ltd.  
[www.peri.com.sa](http://www.peri.com.sa)
- SG** Singapore  
PERI Asia Pte Ltd  
[www.periasia.com](http://www.periasia.com)
- TH** Thailand  
Peri (Thailand) Co., Ltd.  
[www.peri.co.th](http://www.peri.co.th)
- TR** Turkey  
PERI Kalıp ve İskeleleri  
[www.peri.com.tr](http://www.peri.com.tr)
- VN** Vietnam  
PERI ASIA PTE LTD  
[www.peri.com.vn](http://www.peri.com.vn)



# PERI

## PERI GmbH Formwork Scaffolding Engineering

Rudolf-Diesel-Strasse 19  
89264 Weissenhorn  
Germany  
Tel. +49 (0)7309.950-0  
Fax +49 (0)7309.951-0  
info@peri.com  
www.peri.com

## Oceania

**AU** Australia  
PERI Australia Pty. Ltd.  
www.periaus.com.au

**DK** Denmark  
PERI Danmark A/S  
www.peri.dk

**IT** Italy  
PERI S.r.l.  
www.peri.it

**SE** Sweden  
PERI Sverige AB  
www.peri.se

## Europe

**EE** Estonia  
PERI AS  
www.peri.ee

**LT** Lithuania  
PERI UAB  
www.peri.lt

**SI** Slovenia  
PERI oplate i skele d.o.o.  
www.peri.com.hr

**AL** Albania  
PERI Kalıp ve İskeleleri  
www.peri.com.tr

**ES** Spain  
PERI S.A.U.  
www.peri.es

**LU** Luxembourg  
N.V. PERI S.A.  
www.peri.lu

**SK** Slovakia  
PERI spol. s. r.o.  
www.peri.sk

**AT** Austria  
PERI Ges.mBH  
www.peri.at

**FI** Finland  
PERI Suomi Ltd. Oy  
www.perisuomi.fi

**LV** Latvia  
PERI SIA  
www.peri-latvija.lv

**UA** Ukraine  
TOW PERI  
www.peri.ua

**BA** Bosnia and Herzegovina  
PERI oplate i skele d.o.o.  
www.peri.com.hr

**FR** France  
PERI S.A.S.  
www.peri.fr

**NL** Netherlands  
PERI b.v.  
www.peri.nl

**BE** Belgium  
PERI N.V.  
www.peri.be

**GB** United Kingdom  
PERI Ltd.  
www.peri.ltd.uk

**NO** Norway  
PERI Norge AS  
www.peri.no

**BG** Bulgaria  
PERI Bulgaria EOOD  
www.peri.bg

**GR** Greece  
PERI Hellas Ltd.  
www.perihellas.gr

**PL** Poland  
PERI Polska Sp. z o.o.  
www.peri.com.pl

**BY** Belorussia  
IOOO PERI  
www.peri.by

**HR** Croatia  
PERI oplate i skele d.o.o.  
www.peri.com.hr

**PT** Portugal  
Pericofragens Lda.  
www.peri.pt

**CH** Switzerland  
PERI AG  
www.peri.ch

**HU** Hungary  
PERI Kft.  
www.peri.hu

**RO** Romania  
PERI România SRL  
www.peri.ro

**CZ** Czech Republic  
PERI spol. s r.o.  
www.peri.cz

**IR** Ireland  
Siteserv Access & Formwork  
www.siteservaccess.ie

**RS** Serbia  
PERI oplate d.o.o.  
www.peri.rs

**DE** Germany  
PERI GmbH  
www.peri.de

**IS** Iceland  
Armar ehf.  
www.armor.is

**RU** Russia  
OOO PERI  
www.peri.ru

**The optimal System  
for every Project and  
every Requirement**



**Wall Formwork**



**Column Formwork**



**Slab Formwork**



**Climbing Systems**



**Bridge Formwork**



**Tunnel Formwork**



**Shoring Systems**



**Construction Scaffold**



**Facade Scaffold**



**Industrial Scaffold**



**Access**



**Protection Scaffold**



**Safety Systems**



**System-Independent Accessories**



**Services**



**PERI GmbH**  
**Formwork Scaffolding Engineering**  
 Rudolf-Diesel-Strasse 19  
 89264 Weissenhorn  
 Germany  
 Tel. +49 (0)7309.950-0  
 Fax +49 (0)7309.951-0  
 info@peri.com  
 www.peri.com