

QUATTRO

Column formwork designed for moving with only one crane lift

Product Brochure – Issue 03/2019



Issue 03 | 2019

PERI GmbH
Formwork Scaffolding Engineering

Rudolf-Diesel-Strasse 19
89264 Weissenhorn
Germany
Tel. +49 (0)7309.950-0
Fax +49 (0)7309.951-0
info@peri.com
www.peri.com

Important Information

All current safety regulations and guidelines applicable in those countries where our products are used must be observed.

The images shown in this brochure feature construction sites in progress. For this reason, safety and anchor details in particular cannot always be considered conclusive or final. These are subject to the risk assessment carried out by the contractor.

The systems or items shown might not be available in every country.

Safety instructions and load specifications are to be strictly observed at all times. Separate structural calculations are required for any deviations from the standard design data.

The information contained herein is subject to technical changes in the interests of progress. Errors and typographical mistakes reserved.

Content

QUATTRO

- 3 Column formwork designed for moving with only one crane lift

Time-saving

- 4 Moveable as a complete unit, quickly braced and separated

Variable

- 5 Square or rectangular cross-sections from 20 cm x 20 cm to 60 cm x 60 cm

Safe

- 6 Due to the Concreting Platform with integrated Access Ladder and Ladder Safety Cage

High quality

- 7 Powder-coated formwork, best concreting results
- 8 Components



QUATTRO

Column formwork designed for moving with only one crane lift

For contractors, PERI QUATTRO means enormous time-savings when using the crane, because the complete column including the Push-Pull Props and Concreting Platform is moved using only one crane lift. If necessary, QUATTRO can be moved by hand using the Transportation Wheels. QUATTRO is suitable for square or rectangular cross-sections with edge lengths from 20 cm to 60 cm. With four different element heights, height adjustments can be made up to 4.50 m in 25-cm increments.

The permissible fresh concrete pressure of 80 kN/m² allows the customary high concreting speeds when forming the columns. The high-grade plastic formlining is screwed on from the rear, thus resulting in an excellent finish of architectural concrete quality.

■ Time-saving

Moveable as a complete unit, can be quickly braced or separated with a minimum of effort.

■ Variable

Whether square or rectangular, cross-sections from 20 cm x 20 cm to 60 cm x 60 cm in 5-cm increments.

■ Safe

Due to the Concreting Platform with integrated Access Ladder and Ladder Safety Cage.

QUATTRO is equipped with all-plastic formlining, ensuring an excellent concrete finish.



Time-saving

Moveable as a complete unit, quickly braced and separated

PERI QUATTRO Column Formwork can be moved as a complete unit, including the Push-Pull Props and Concreting Platform, in just one crane lift. Alternatively, the unit can be moved by hand using four Transportation Wheels per column.

Shuttering and striking are also carried out easily and quickly: elements are braced and separated in just a few simple steps – all required components are fixed directly on the column formwork.

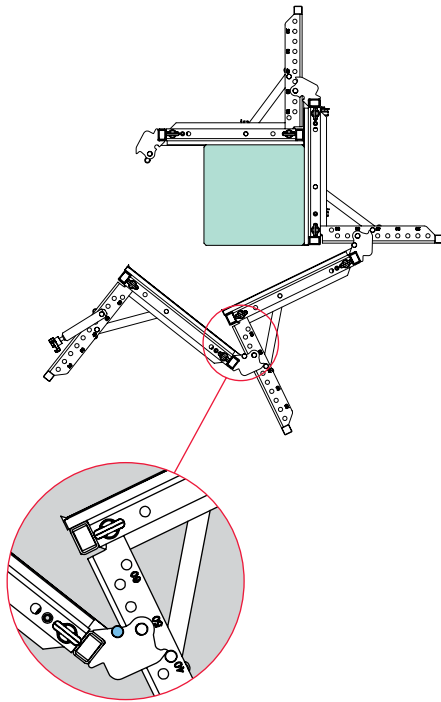

The frame must be secured in the "hold-open position" by means of an additional bolt.

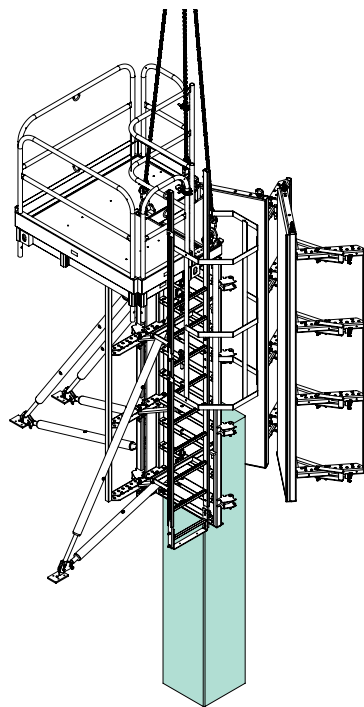

The formwork can then be attached to the crane lifting gear and moved to the next place of use.

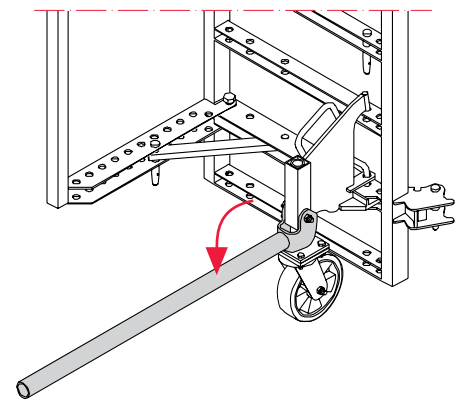
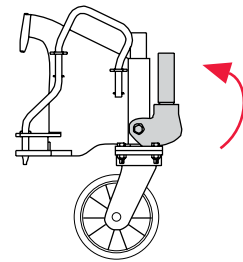

Formwork up to a max. height of 3.50 m may be moved by means of the Transportation Wheels. For this, four Transportation Wheels are to be mounted on the closed formwork unit.

Variable

Square or rectangular cross-sections from 20 cm x 20 cm to 60 cm x 60 cm

With QUATTRO, square or rectangular column cross-sections from 20 cm x 20 cm to 60 cm x 60 cm can be realised in 5-cm increments. With 4 different element heights of 0.50 m, 1.25 m, 2.75 m and 3.50 m respectively, height adjustments are possible in 25-cm increments up to 4.50 m. In addition, elements can easily be connected by means of Ring Bolts, which also serve as crane lifting gear.

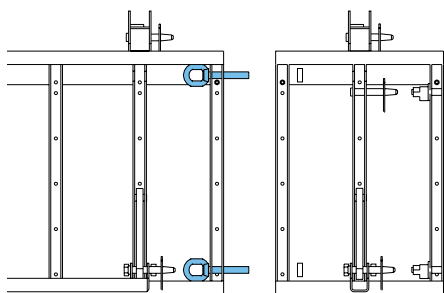
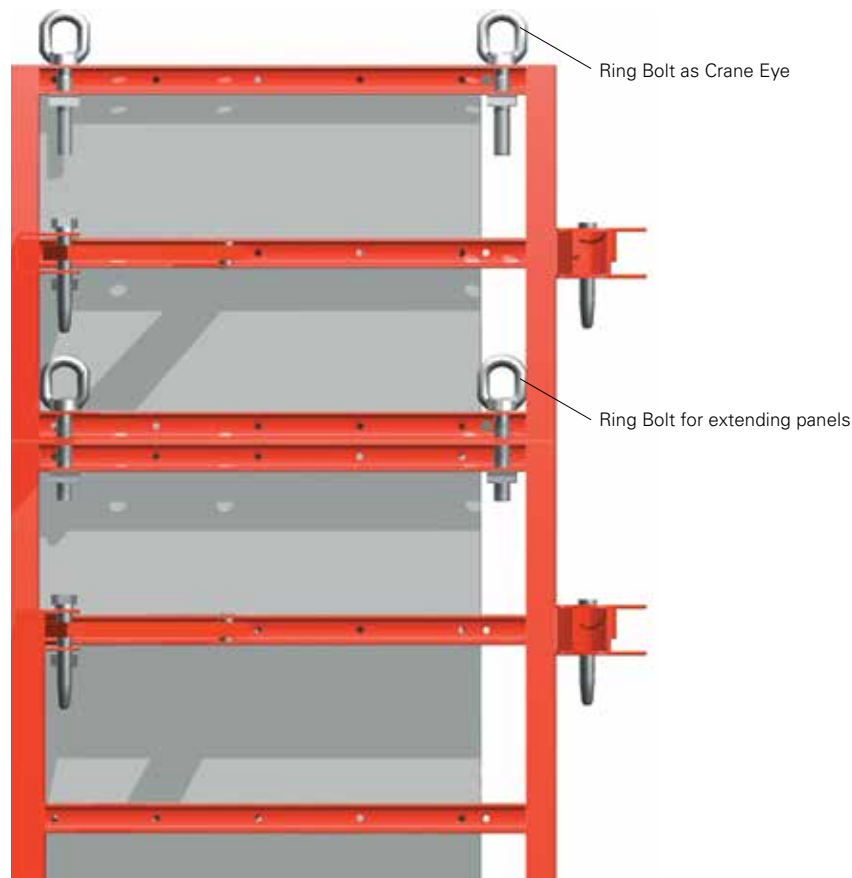

The individual elements are connected using Ring Bolts.

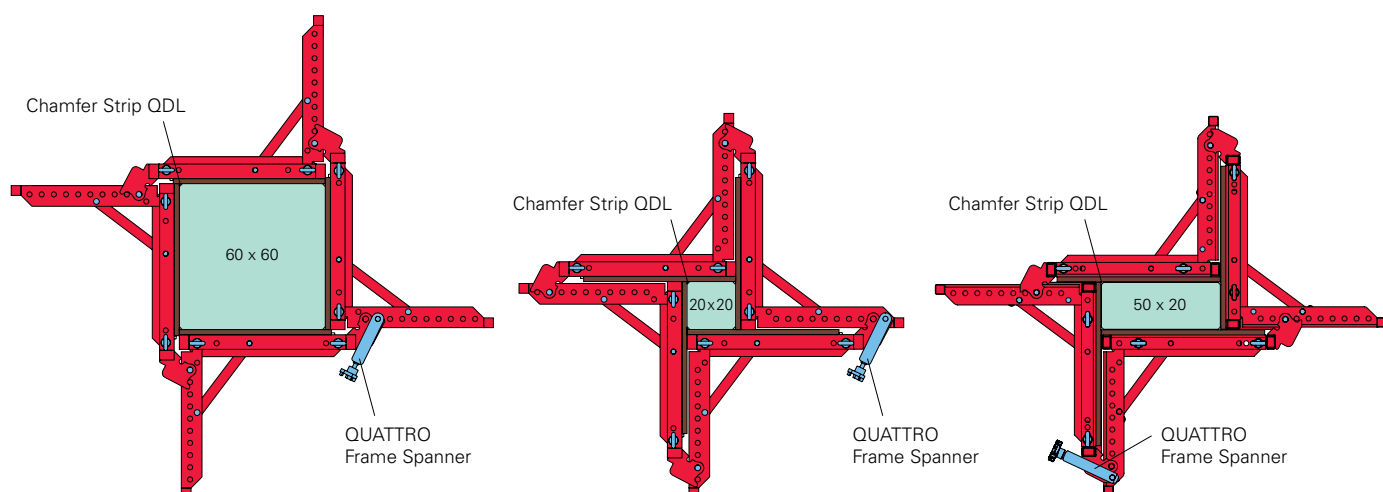

Safe

Due to the Concreting Platform with integrated Access Ladder and Ladder Safety Cage



The aluminium platform suits any layout from 20 cm x 20 cm to 60 cm x 60 cm. Thanks to its low weight, it can easily be assembled by hand. Another advantage is that the mounting of the Concreting Platform also serves as the crane suspension.

The PERI Concreting Platform is delivered to the construction site ready for use. There are no individual components which can be lost and no time-consuming assembly of individual scaffold brackets, planking or handrail boards.

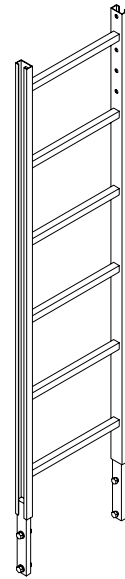

Ladder 180/6

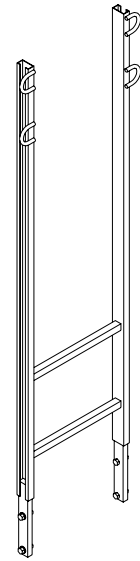

End Ladder 180/2

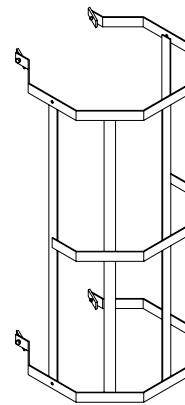

Ladder Safety Cage 150

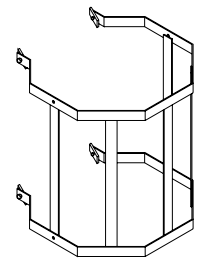

Ladder Safety Cage 75

Integrated ladders serve to ensure safe access to the Concreting Platforms. They consist of a Ladder Cage, Access Ladder, Ladder Connection and Ladder Hooks. Once installed, they are moved as a complete unit together with the formwork.

High quality

Powder-coated formwork, best concreting results



QUATTRO Column Formwork is provided with high-quality powder coating.



For storage and transportation, the four elements are placed one on top of the other in a stack – extremely compact thanks to the stacking height of only 12 cm.

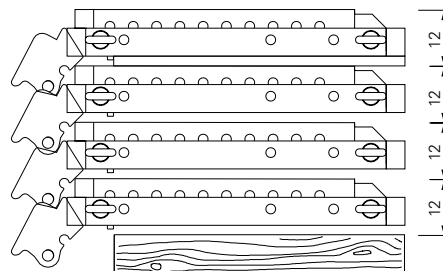

The frames of the QUATTRO Column Formwork are powder-coated. This reliably prevents the concrete from sticking and guarantees easy cleaning.

Due to the high-grade plastic formlining being screwed on from the rear, an excellent architectural concrete finish is achieved – no nail or screw markings.* The maximum permissible fresh concrete pressure for QUATTRO Column Formwork is 80 kN/m² and has been designed to accommodate the high concreting speeds customary when forming columns.

*With new plywood and without height extensions.

Thanks to the high-quality formlining that is screwed on from the rear, excellent architectural concrete finishes can be achieved with QUATTRO.

Item no.	Weight kg
109926	199.000

QUATTRO Frame QES 350

Column Panel with 20 mm plywood, screwed on from behind. For cross-sections in 5-cm-increments from 20 x 20 cm to 60 x 60 cm. Eye bolt as load-bearing point and for extensions. Without chamfer strip.

Complete with

- 2 pc. 724812 Stair Tower Eye Bolt M20 x 110, galv.
- 2 pc. 710045 Nut DIN 557-4 M20, galv.
- 13 pc. 105400 Pin Ø 20 x 140, galv.
- 13 pc. 018060 Cotter Pin 4/1, galv.
- 1 pc. 037550 Base Plate QUATTRO QB

Technical Data

Permissible load-bearing point capacity 1.0 t.

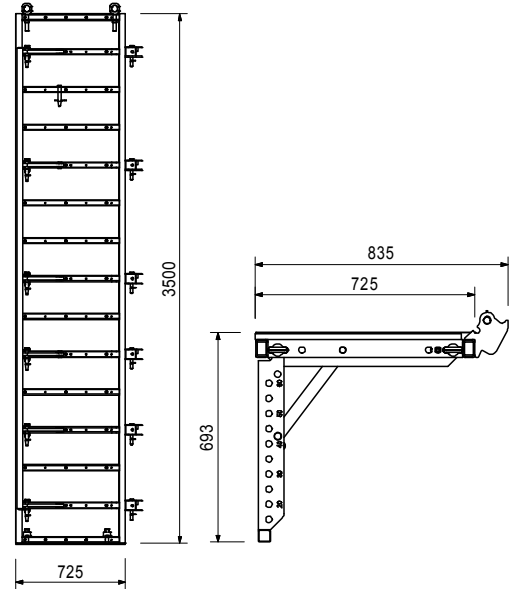
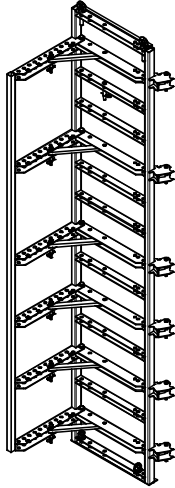

Accessories

105400	0.330
018060	0.014

- Pin Ø 20 x 140, galv.**
- Cotter Pin 4/1, galv.**

109925	152.000
--------	---------

QUATTRO Frame QES 275

Column Panel with 20 mm plywood, screwed on from behind. For cross-sections in 5-cm-increments from 20 x 20 cm to 60 x 60 cm. Eye bolt as load-bearing point and for extensions. Without chamfer strip.

Complete with

- 2 pc. 724812 Stair Tower Eye Bolt M20 x 110, galv.
- 2 pc. 710045 Nut DIN 557-4 M20, galv.
- 9 pc. 105400 Pin Ø 20 x 140, galv.
- 9 pc. 018060 Cotter Pin 4/1, galv.
- 1 pc. 037550 Base Plate QUATTRO QB

Technical Data

Permissible load-bearing point capacity 1.0 t.

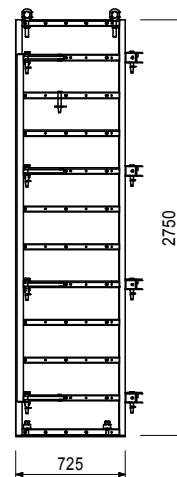
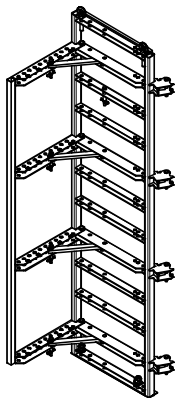

Item no.	Weight kg
109924	71.100

QUATTRO Frame QES 125

Column Panel with 20 mm plywood, screwed on from behind. For cross-sections in 5-cm-increments from 20 x 20 cm to 60 x 60 cm. Eye bolt as load-bearing point and for extensions. Without chamfer strip.

Complete with

- 2 pc. 724812 Stair Tower Eye Bolt M20 x 110, galv.
- 2 pc. 710045 Nut DIN 557-4 M20, galv.
- 5 pc. 105400 Pin Ø 20 x 140, galv.
- 5 pc. 018060 Cotter Pin 4/1, galv.

Technical Data

Permissible load-bearing point capacity 1.0 t.

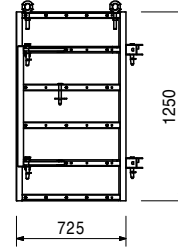
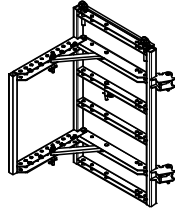

109923	31.200
--------	--------

QUATTRO Frame QES 50

Column Panel with 20 mm plywood, screwed on from behind. For cross-sections in 5-cm-increments from 20 x 20 cm to 60 x 60 cm. Eye bolt as load-bearing point and for extensions. Without chamfer strip.

Complete with

- 2 pc. 724812 Stair Tower Eye Bolt M20 x 110, galv.
- 2 pc. 710045 Nut DIN 557-4 M20, galv.
- 2 pc. 105400 Pin Ø 20 x 140, galv.
- 2 pc. 018060 Cotter Pin 4/1, galv.

Technical Data

Permissible load-bearing point capacity 1.0 t.

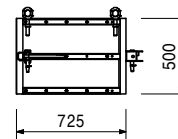
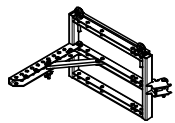

105448	0.665
037610	0.520
037600	0.230
037590	0.100

Chamfer Strips QDL

Chamfer Strip QDL 350

Chamfer Strip QDL 275

Chamfer Strip QDL 125

Chamfer Strip QDL 50

Plastic chamfer strip with nailing panel. Edge length 15 x 15 mm.

L

3500

2750

1250

500

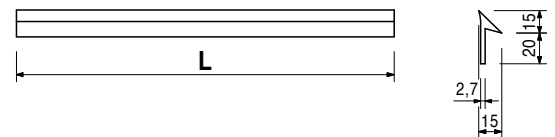
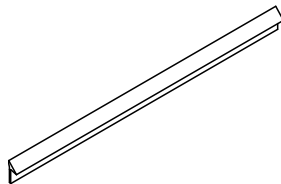

037550	3.240
--------	-------

Base Plate QUATTRO QB

For protecting the plywood formlining against damage.

Complete with

- 2 pc. 030130 Cam Nut DW 15, galv.

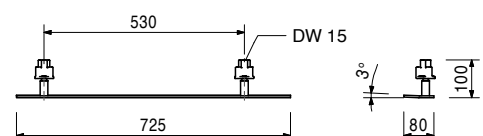
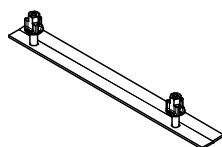

QUATTRO Column Formwork



Item no.	Weight kg
037540	2.370

Frame Spanner QUATTRO QA
For bracing QUATTRO Column Panels. Only required at a column corner.

Note
Required no. of pieces:
h = 3.50 m 6 pieces, h = 2.75 m 4 pieces
h = 1.25 m 2 pieces, h = 0.50 m 1 piece

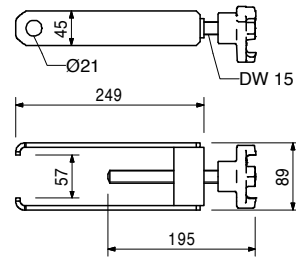
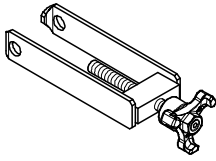

105400	0.330
018060	0.014

Accessories
Pin Ø 20 x 140, galv.
Cotter Pin 4/1, galv.

037530	1.130
--------	-------

Brace Connector QUATTRO QR
For connecting push-pull props and kicker braces to QUATTRO and LICO Panels.

Complete with
1 pc. 027170 Pin Ø 16 x 42, galv.
1 pc. 018060 Cotter Pin 4/1, galv.

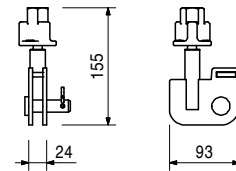
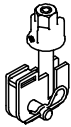

724500	0.098
--------	-------

Bolt Ø 20 x 42, QUATTRO, galv.
For different connections.

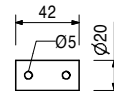

018060	0.014
--------	-------

Accessories
Cotter Pin 4/1, galv.

105400	0.330
--------	-------

Pin Ø 20 x 140, galv.
For different connections.

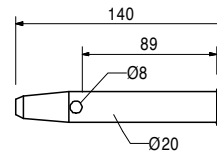
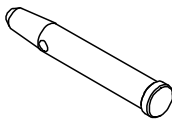

018060	0.014
--------	-------

Accessories
Cotter Pin 4/1, galv.

Item no.	Weight kg
018060	0.014

Cotter Pin 4/1, galv.

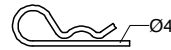

105791	16.900
--------	--------

Transportation Wheel QUATTRO

For moving completely assembled QUATTRO Column Formwork. Always use 4 pieces per column.

Technical Data

Permissible load-bearing capacity 500 kg.

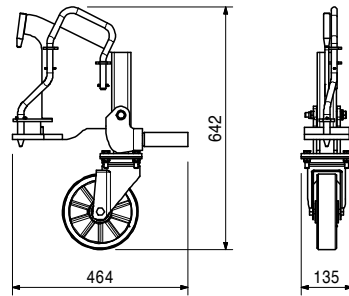
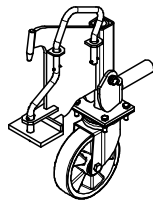

103391	4.890
--------	-------

Ladder Connector QUATTRO

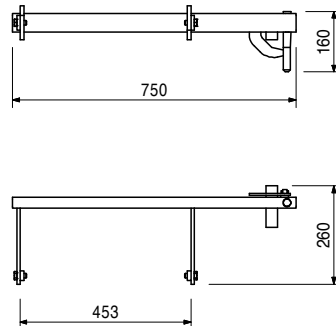
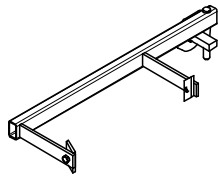

127260	9.240
--------	-------

QUATTRO Ladder Connector-2

For connecting ladders to QUATTRO Column Panels.

Complete with

2 pc. 710266 Bolt ISO 4017 M12 x 25-8.8, galv.
2 pc. 701763 Clamping Plate FI 25 x 10 x 90

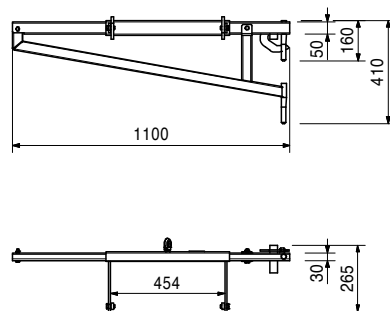
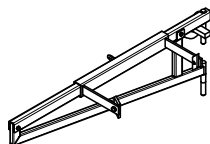

QUATTRO Column Formwork



Item no.	Weight kg
037400	123.000

Concreting Platform, compl.

Working and concreting platform for TRIO, RAPID and QUATTRO Column Formwork.

Complete with

- 1 pc. 037410 Concreting Landing, Alu
- 2 pc. 037420 Platform Guardrail 52, galv.
- 2 pc. 037430 Platform Guardrail 134, galv.
- 3 pc. 037440 Crane Hook Concreting Platform

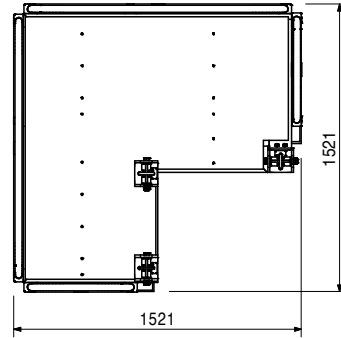
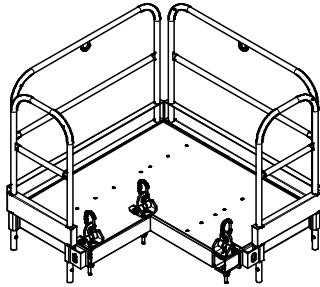

037410	51.400
--------	--------

Concreting Landing, Alu

Adjusts continuously to all column cross-sections up to max. 60 x 60 cm. Attachment is carried out using the crane eye of the concreting platform.

Technical Data

Permissible load 150 kg/m².

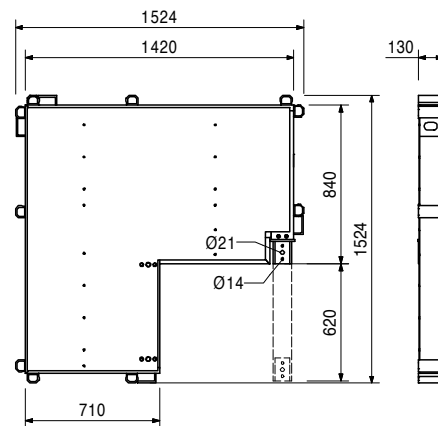
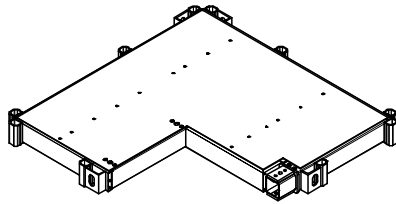

037420	10.200
--------	--------

Platform Guardrail 52, galv.

As guardrail for PERI Concreting Platforms. Locks in place automatically.

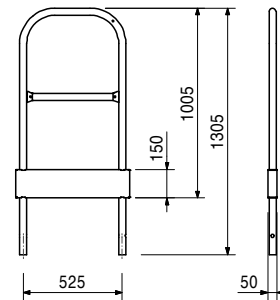
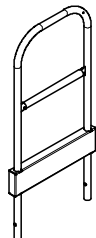

QUATTRO Column Formwork



Item no.	Weight kg
037430	17.100

Platform Guardrail 134, galv.

As guardrail for PERI Concreting Platforms. Locks in place automatically.

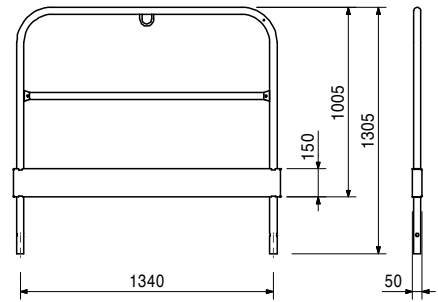
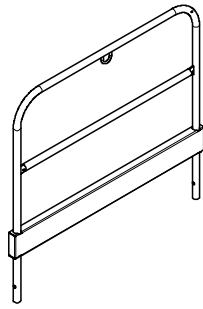

115352	15.300
--------	--------

Platform Front Guardrail 86/86

As guardrail for PERI Concreting Platforms towards the column. Mounted with Screw-on Coupler.

Note

Wrench size SW 19.

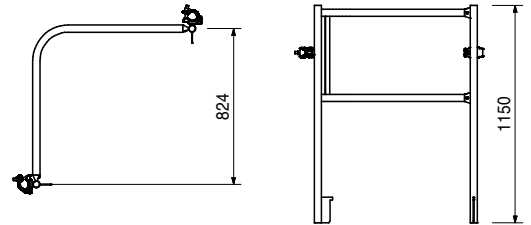
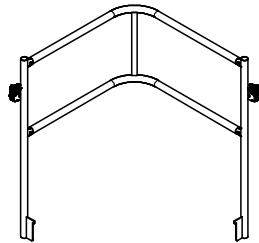

037440	5.640
--------	-------

Crane Hook Concreting Platform

For assembling the concreting landing to the TRIO, RAPID and QUATTRO column frames.

Note

Follow Instructions for Assembly and Use!

Technical Data

Permissible load-bearing capacity 1.0 t.

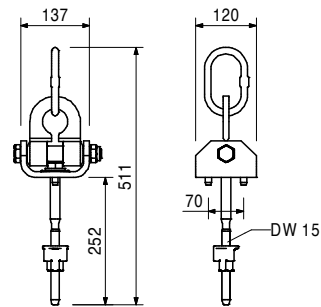
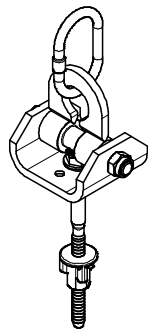

051460	2.180
--------	-------

Ladder Base, galv.

As bottom ladder connection and for securing ladders against sliding on the scaffold decks.

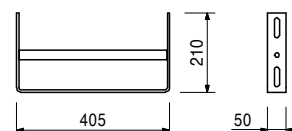
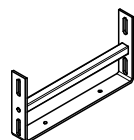

QUATTRO Column Formwork



Item no.	Weight kg
051410	11.700

Ladder 180/6, galv.
As access for PERI Formwork Systems.

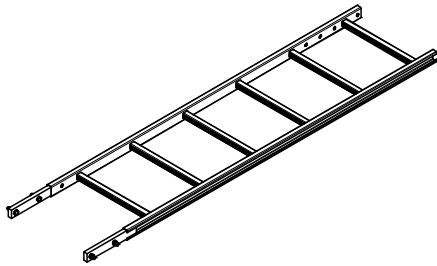

Complete with
4 pc. 710224 Bolt ISO 4017 M12 x 40-8.8, galv.
4 pc. 710381 Nut ISO 7042 M12-8, galv.

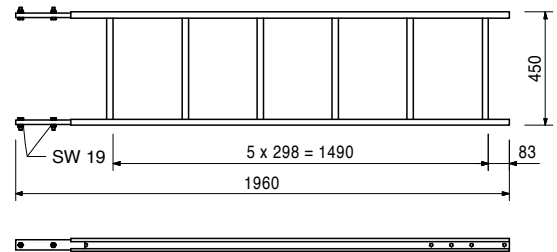

103724	10.400
--------	--------

End Ladder 180/2, galv.
As access for PERI Formwork Systems.

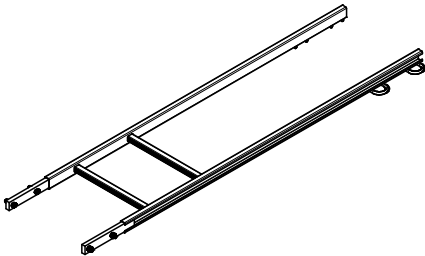

Complete with
4 pc. 710224 Bolt ISO 4017 M12 x 40-8.8, galv.
4 pc. 710381 Nut ISO 7042 M12-8, galv.

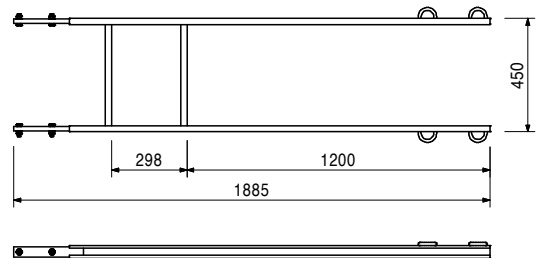

104132	15.600
051450	25.200

Lader Safety Cages, galv.
Ladder Safety Cage 75, galv.
Ladder Safety Cage 150, galv.
Ladder safety cage for PERI Access Ladders.

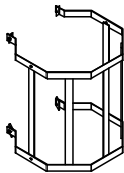

Complete with
4 pc. 710266 Bolt ISO 4017 M12 x 25-8.8, galv.
4 pc. 701763 Clamping Plate FI 25 x 10 x 90

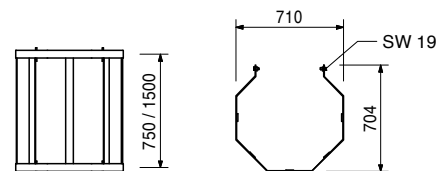

103718	0.684
--------	-------

Ladder Hook, galv.
For adjusting the bottom ladder.
Always use in pairs.



Complete with
2 pc. 710266 Bolt ISO 4017 M12 x 25-8.8, galv.
2 pc. 710381 Nut ISO 7042 M12-8, galv.

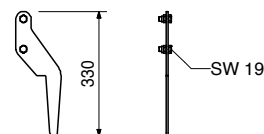

QUATTRO Column Formwork



Item no.	Weight kg
117466	10.600

Push-Pull Prop RS 210, galv.

Extension length $l = 1.30 - 2.10$ m.
For aligning PERI Formwork Systems and precast concrete elements.

Note

Permissible load see PERI Design Tables.

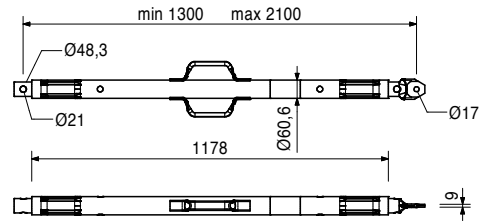
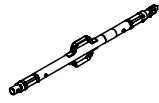

118238	12.100
--------	--------

Push-Pull Prop RS 260, galv.

Extension length $l = 2.30 - 2.60$ m.
For aligning PERI Formwork Systems and precast concrete elements.

Note

Permissible load see PERI Design Tables.

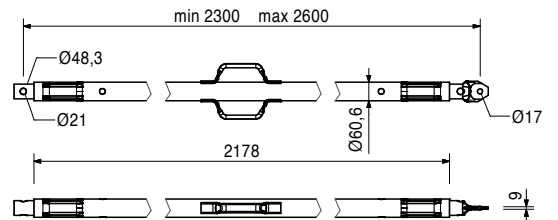
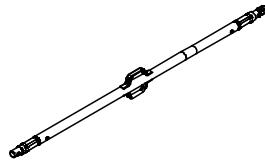

117467	15.500
--------	--------

Push-Pull Prop RS 300, galv.

Extension length $l = 1.90 - 3.00$ m.
For aligning PERI Formwork Systems and precast concrete elements.

Note

Permissible load see PERI Design Tables.

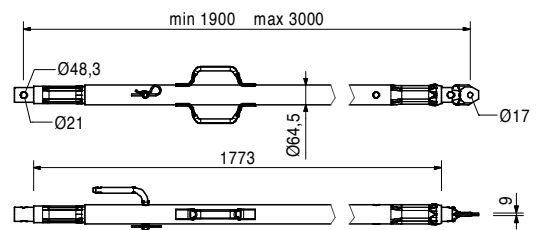
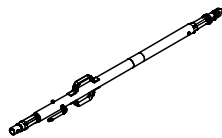

117468	23.000
--------	--------

Push-Pull Prop RS 450, galv.

Extension length $l = 2.80 - 4.50$ m.
For aligning PERI Formwork Systems and precast concrete elements.

Note

Permissible load see PERI Design Tables.

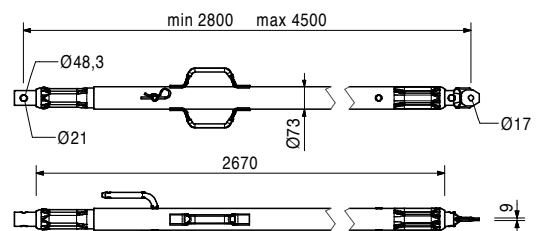
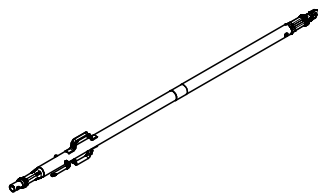

QUATTRO Column Formwork



Item no.	Weight kg
117469	39.900

Push-Pull Prop RS 650, galv.
 Extension length $l = 4.30 - 6.50$ m.
 For aligning PERI Formwork Systems and precast concrete elements.

Note
 Permissible load see PERI Design Tables.

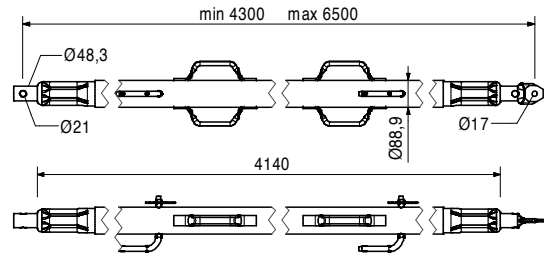
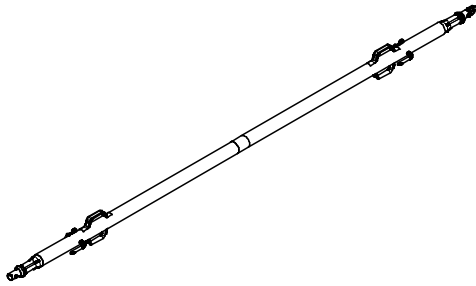

028990	115.000
--------	---------

Push-Pull Prop RS 1000, galv.
 Extension length $l = 6.40 - 10.00$ m.
 For aligning PERI Formwork Systems.

Note
 Permissible load see PERI Design Tables.

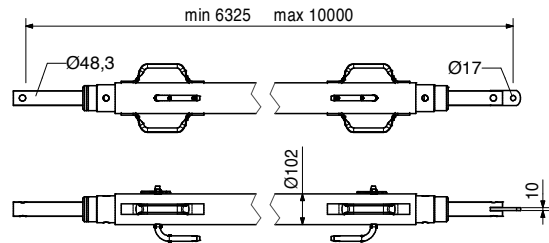
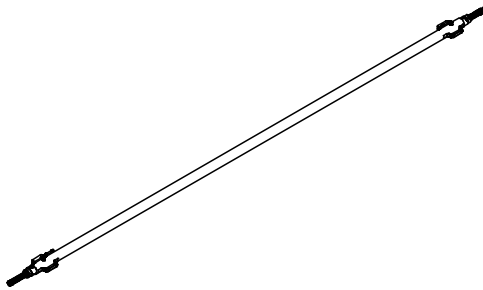

103800	271.000
--------	---------

Push-Pull Prop RS 1400, galv.
 Extension length $l = 6.40 - 14.00$ m.
 For aligning PERI Formwork Systems.

Note
 Permissible load see PERI Design Tables.
 Chain can be operated from bottom.

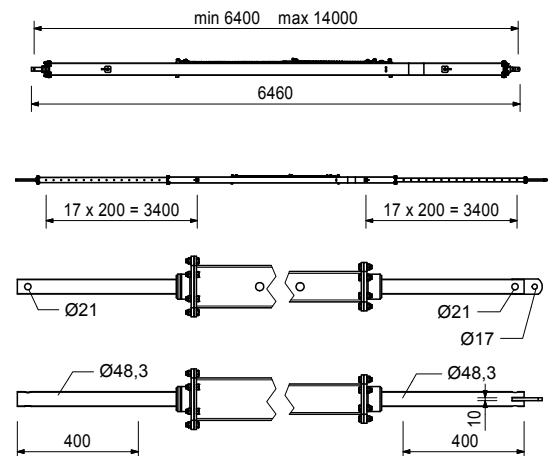
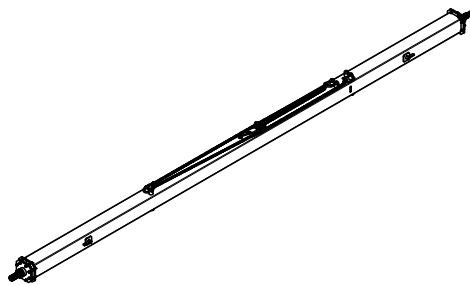

Item no.	Weight kg
126666	3.070

Base Plate-3 for RS 210 - 1400

For assembly of Push-Pull Props RS 210, 260, 300, 450, 650, 1000 and 1400.

Complete with

- 2 pc. 105400 Pin Ø 20 x 140, galv.
- 2 pc. 018060 Cotter Pin 4/1, galv.
- 1 pc. 113063 Bolt ISO 4014 M12 x 80-8.8, galv.
- 1 pc. 113064 Hex Nut ISO7042-M12-8-G, galv.

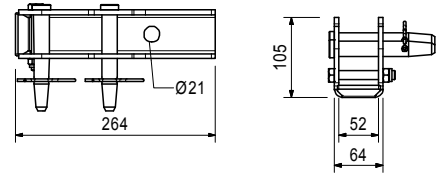
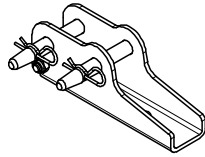

Accessories

124777	0.210
--------	-------

Anchor Bolt PERI 14/20 x 130

102018	4.880
--------	-------

Base Plate-2 for RS 1000/1400, galv.

For assembly of Push-Pull Props RS 210, 260, 300, 450, 650, 1000, 1400 and Heavy Duty Spindles.

Complete with

- 2 pc. 105400 Pin Ø 20 x 140, galv.
- 2 pc. 018060 Cotter Pin 4/1, galv.

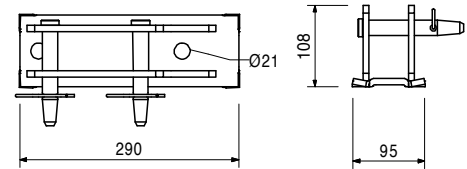
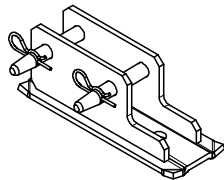

117343	3.250
--------	-------

Base Plate-2 for RS 210 - 1400, galv.

For assembly of Push-Pull Props RS 210, 260, 300, 450, 650, 1000 and 1400.

Complete with

- 2 pc. 105400 Pin Ø 20 x 140, galv.
- 2 pc. 018060 Cotter Pin 4/1, galv.

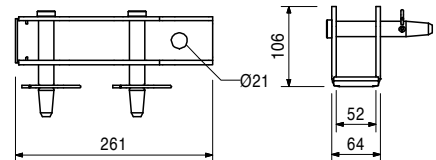
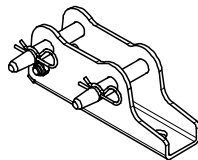

Accessories

124777	0.210
--------	-------

Anchor Bolt PERI 14/20 x 130

028010	17.900
--------	--------

Push-Pull Prop RSS I

Extension length l = 2.05 – 2.94 m.
For aligning PERI Formwork Systems.

Note

Permissible load see PERI Design Tables.

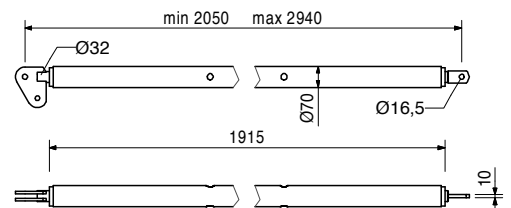
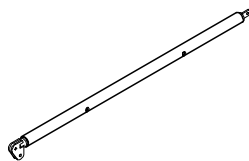

Accessories

113397	1.600
--------	-------

Spindle Handle RSS / AV

Item no.	Weight kg
113397	1.600

Spindle Handle RSS / AV

Spindle handle for screwing on Push-Pull-Props RSS I, RSS II and Kickers AV 210 and AV RSS III.

Complete with

2 pc. 722342 Screw ISO 4017 M8 x 25-8.8, galv.
2 pc. 711071 Nut ISO 7042 M8-8, galv.

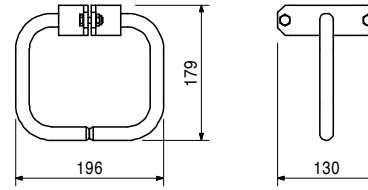
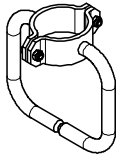

028020	22.000
--------	--------

Push-Pull Prop RSS II

Extension length $l = 2.91 - 3.80$ m.
For aligning PERI Formwork Systems.

Note

Permissible load see PERI Design Tables.

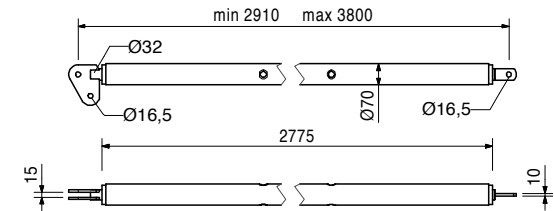
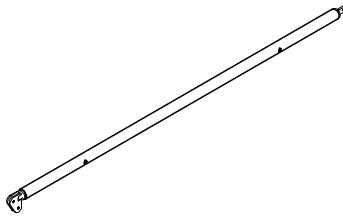

Accessories

113397	1.600
--------	-------

Spindle Handle RSS / AV

028030	38.400
--------	--------

Push-Pull Prop RSS III

Extension length $l = 4.60 - 6.00$ m.
For aligning PERI Formwork Systems.

Note

Permissible load see PERI Design Tables.

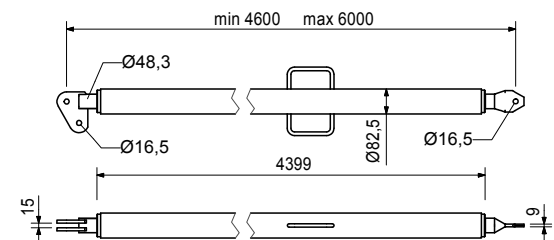
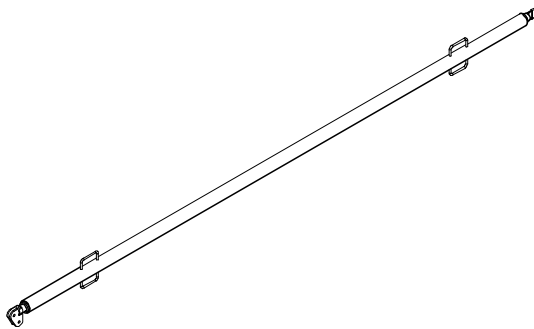

106000	1.820
--------	-------

Base Plate-2 for RSS, galv.

For assembly of Push-Pull Props RSS.

Complete with

1 pc. 027170 Pin $\varnothing 16 \times 42$, galv.
1 pc. 018060 Cotter Pin 4/1, galv.

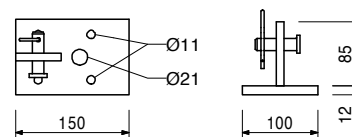
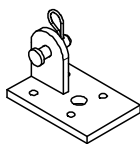

Accessories

124777	0.210
--------	-------

Anchor Bolt PERI 14/20 x 130

QUATTRO Column Formwork



Item no.	Weight kg
057087	3.510
057088	4.200

Kicker AV
Kicker AV 82
Kicker AV 111
 For aligning PERI Formwork Systems.

min. L	max. L
500	820
790	1110

Complete with
 1 pc. 027170 Pin Ø 16 x 42, galv.
 1 pc. 018060 Cotter Pin 4/1, galv.

Note
 Permissible load see PERI Design Tables.

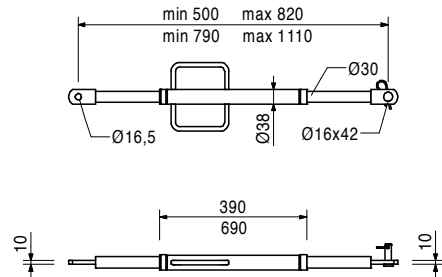
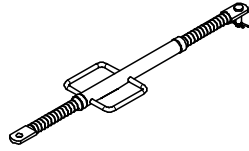

028110	4.850
--------	-------

Kicker AV 140
 Extension length l = 1.08 – 1.40 m.
 For aligning PERI Formwork Systems.

Complete with
 1 pc. 027170 Pin Ø 16 x 42, galv.
 1 pc. 018060 Cotter Pin 4/1, galv.

Note
 Permissible load see PERI Design Tables.

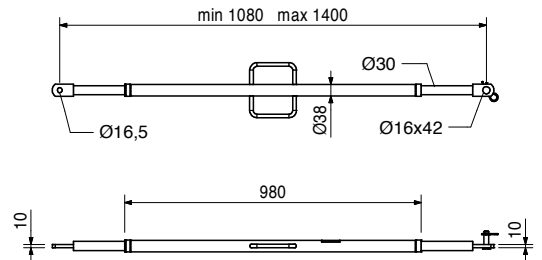
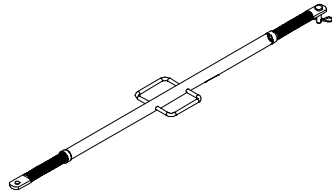

108135	12.900
--------	--------

Kicker AV 210
 Extension length l = 1.28 – 2.10 m.
 For aligning PERI Formwork Systems.

Complete with
 1 pc. 027170 Pin Ø 16 x 42, galv.
 1 pc. 018060 Cotter Pin 4/1, galv.

Note
 Permissible load see PERI Design Tables.

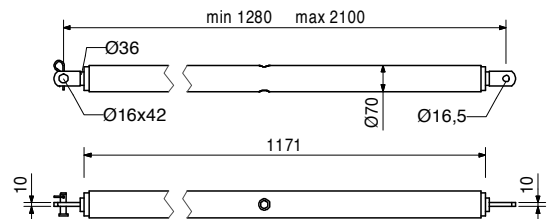
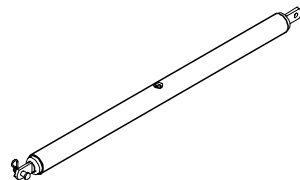

113397	1.600
--------	-------

Accessories
Spindle Handle RSS / AV

Item no.	Weight kg
028120	17.000

Kicker AV RSS III

Extension length l = 2.03 – 2.92 m.
For aligning PERI Formwork Systems.

Complete with

1 pc. 027170 Pin Ø 16 x 42, galv.
1 pc. 018060 Cotter Pin 4/1, galv.

Note

Permissible load see PERI Design Tables.

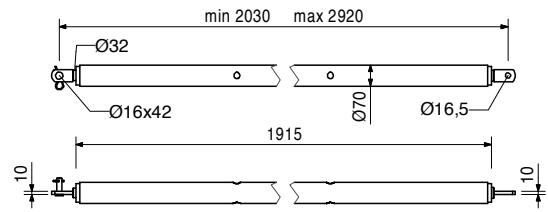
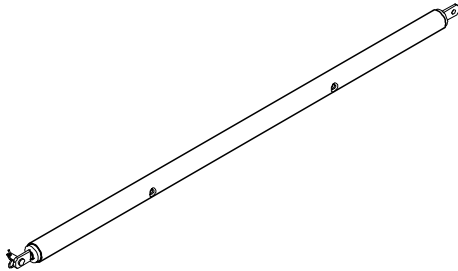

Item no.	Weight kg
113397	1.600

Accessories

Spindle Handle RSS / AV

Item no.	Weight kg
028080	2.970

Connector Kicker/Push-Pull Prop, galv.

For connecting push-pull props and kicker braces to Main Beam HDT.

Complete with

1 pc. 027170 Pin Ø 16 x 42, galv.
1 pc. 018060 Cotter Pin 4/1, galv.

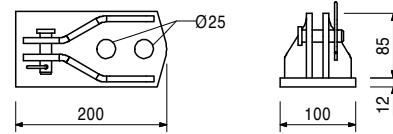
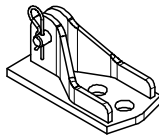

Item no.	Weight kg
124777	0.210

Anchor Bolt PERI 14/20 x 130

For temporary fixation to reinforced concrete structures.

Note

See PERI Data Sheet!
Drilling Ø 14 mm.

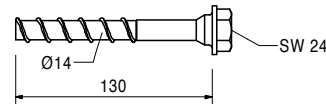
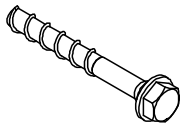

**The optimal System
for every Project and
every Requirement**



Wall Formwork



Column Formwork



Slab Formwork



Climbing Systems



Bridge Formwork



Tunnel Formwork



Shoring Systems



Construction Scaffold



Facade Scaffold



Industrial Scaffold



Access



Protection Scaffold



Safety Systems



**System-Independent
Accessories**



Services



PERI GmbH
Formwork Scaffolding Engineering
 Rudolf-Diesel-Strasse 19
 89264 Weissenhorn
 Germany
 Tel. +49 (0)7309.950-0
 Fax +49 (0)7309.951-0
 info@peri.com
 www.peri.com

